

REVISION HISTORY			
REV	DESCRIPTION	DATE	APPROVED
2	ECO 03429	12/6/2011	CDM

Bill of Material						
ITEM	PART NUMBER	STOCK NUMBER	QTY	DESCRIPTION	FILE NAME	REV
1			1	MOUNTING BRACKET	I015182.ipt	2
2		S01-002	4	CABLE RING	I015183.ipt	2

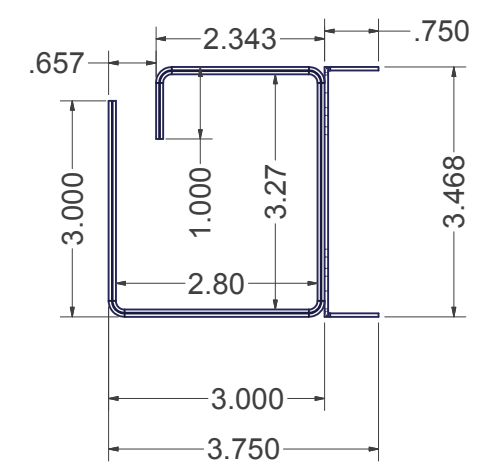
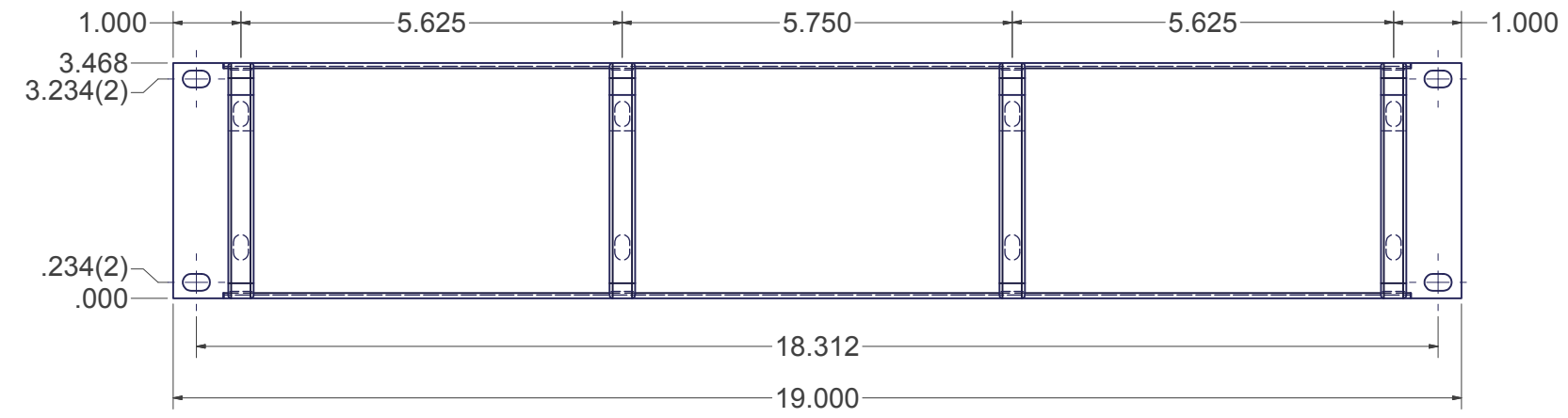
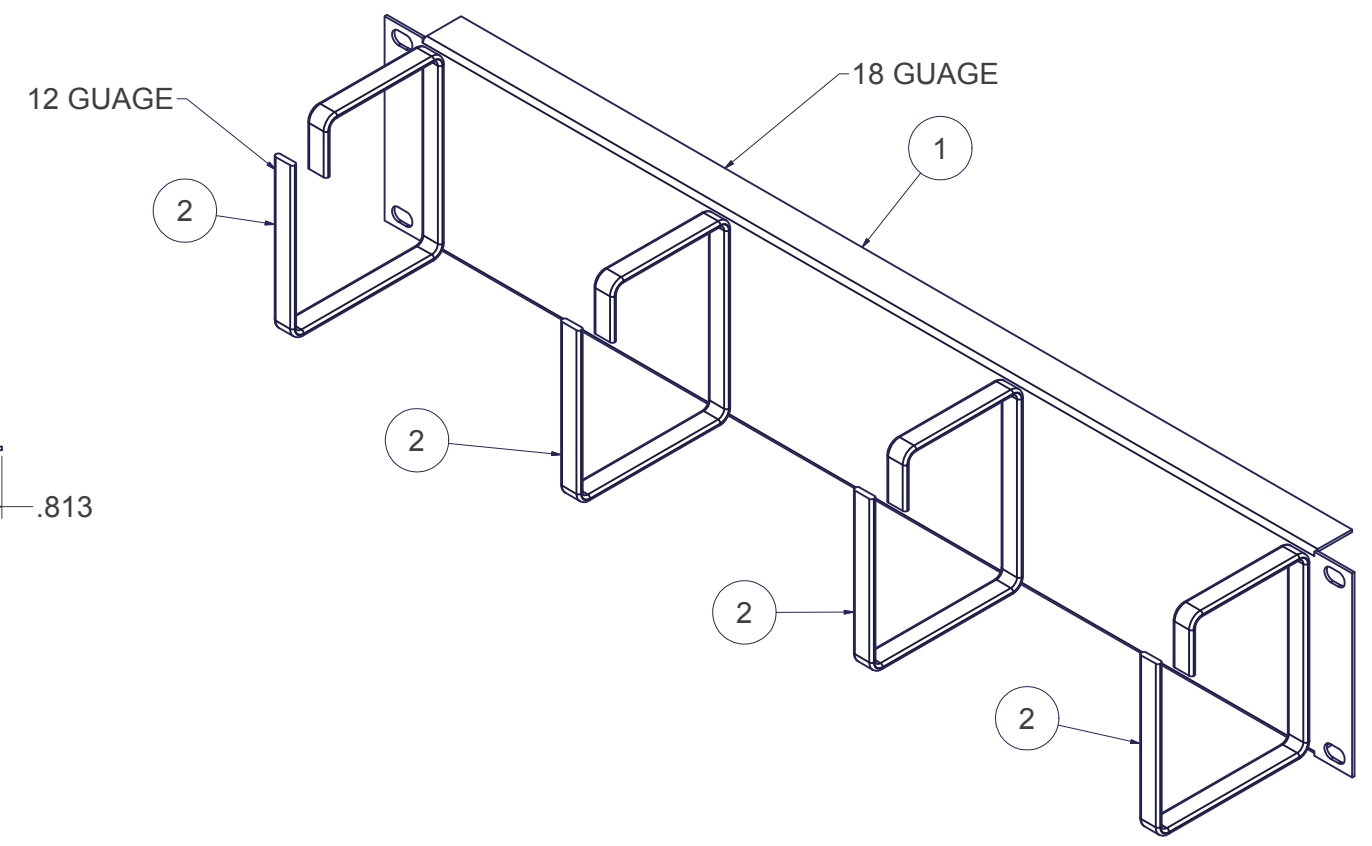
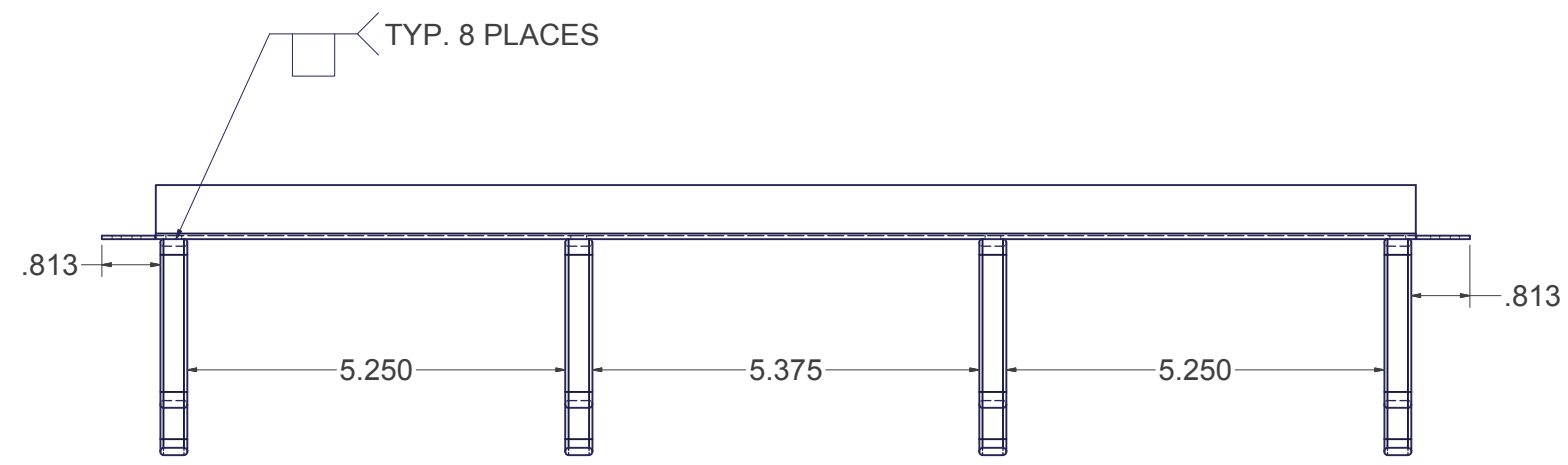

- SPECIAL NOTES:**
- 1) FINISH PER TD-09-103 (POWDER COAT), CLASS B, TEXTURE LEVEL 3, - ALL SURFACES UNLESS OTHERWISE NOTED.
 - 2) DIMENSIONS APPLY BEFORE APPLICATION OF FINISH: ADD .005" TO EACH SURFACE FOR INSPECTION.
 - 3) CENTER CABLE RINGS TO THE WELD SLOTS AND FLUSH TO THE TOP OF THE MOUNTING BRACKET PRIOR TO WELDING.

INTERPRET DRAWING PER ASME Y14.5M-1994
DIMENSIONAL LIMITS APPLY AFTER APPLICATION OF FINISH
DRAWING NOT TO SCALE
TOLERANCE UNLESS OTHERWISE NOTED:
ANGULAR +/- .1°
.XXXX +/- .010
.XXX +/- .015
.XX +/- .030
.X FOR REF. ONLY
UNLESS OTHERWISE SPECIFIED ALL DIMENSIONS ARE IN INCHES

NOTICE:
Use of this document is subject to a confidentiality and nondisclosure agreement with Great Lakes Case & Cabinet Co., Inc. (GLCC) and may not be reproduced, disclosed or utilized in whole or in part without prior written authorization from GLCC.

PART NUMBER: CM04
QTY PER UNIT: 1
MATERIAL TYPE: _____
MATERIAL GAUGE: SEE DETAILS
FINISH: SEE NOTES
DRAWN: CDM DATE: 12/5/2011
CHECKED & APP: WSS DATE: 12/08/2011

TITLE: INTERBAY CABLE ORGANIZER	
GREAT LAKES CASE & CABINET CO., INC. P.O. BOX 551 EDINBORO, PA 16412 PHONE (814) 734-7303 FAX (814) 734-3907 E-MAIL glcc@greatcabinets.com	
DWG NO: I015181	REV: 2
SHEET: 1 OF 1	

