

Bill of Material					
ITEM	PART NUMBER	QTY	DESCRIPTION	FILE NAME	REVISION
1	7206SLX101	1	SLIDING SHELF SURFACE, 19" EIA MOUNTING	I0009.02.iam	4
2	7206SLX102	1	19" EIA SLIDING SHELF MOUNTING BRACKET WELDMENT	I0009.03.iam	4
3	XS14	2	JONATHAN 14" SLIDE	XS14.iam	-
4	-	14	#8-32 x 1/4" L PAN HEAD PHIL TYPE 23 SCREW, ZINC PLATED	SCR832X250BLK.jpt	-

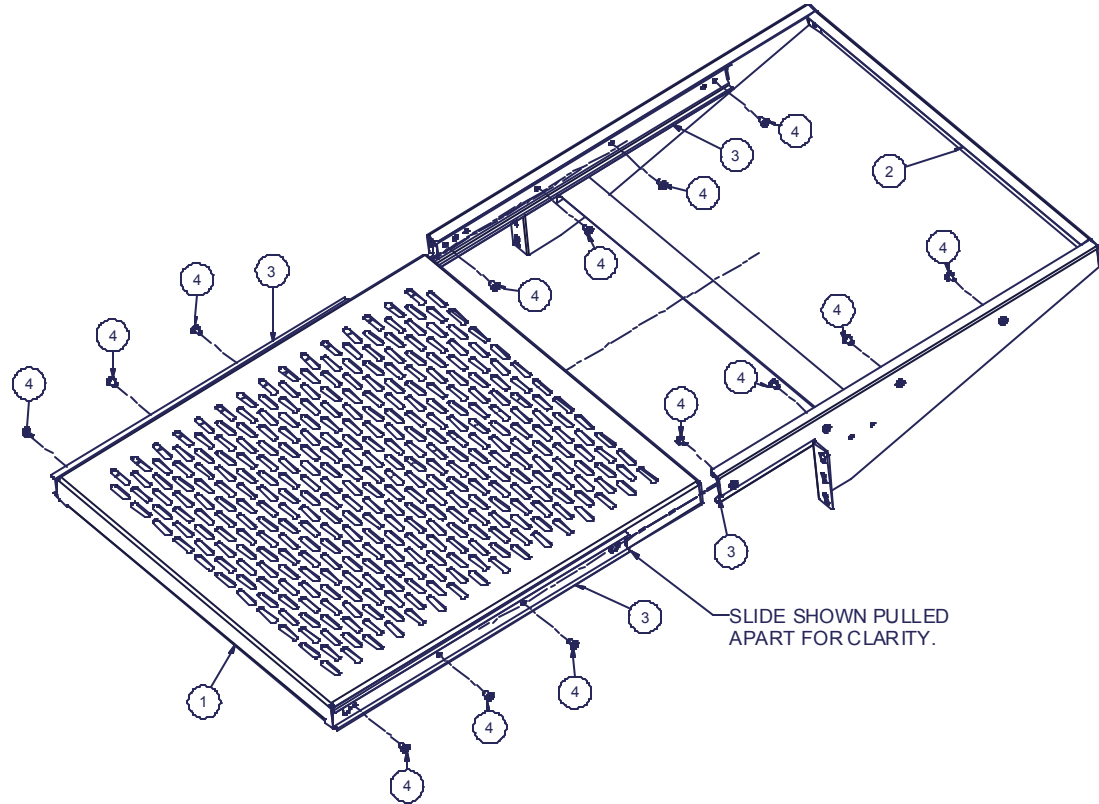

SLIDE SHOWN PULLED APART FOR CLARITY.

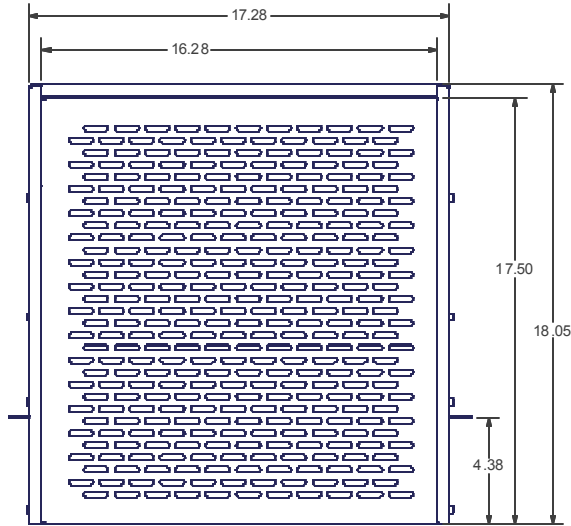
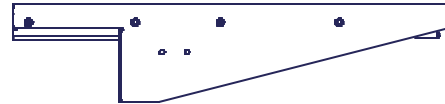
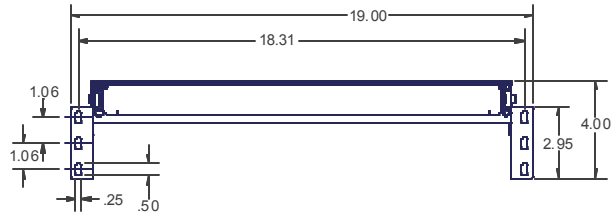

NOTES:

- 1) 19" EIA MOUNTING
- 2) 10.94" SLIDE TRAVEL
- 3) 40 LBS. WEIGHT CAPACITY.

IN TERPRET DRAWING PER ASME Y14.5M-1994 DIMENSIONAL LIMITS APPLY AFTER APPLICATION OF FINISH DRAWING NOT TO SCALE TOLERANCE UNLESS OTHERWISE NOTED: ANGULAR +/- .1 .XXX +/- .010 .XX +/- .015 .X +/- .030 X FOR REF. ONLY UNLESS OTHERWISE SPECIFIED ALL DIMENSIONS ARE IN INCHES
--

NOTICE:

Use of this document is subject to a confidentiality and nondisclosure agreement with Great Lakes Case & Cabinet Co., Inc. (GLCC) and may not be reproduced, disclosed or utilized in whole or in part without prior written authorization from GLCC.

PART NUMBER: 7206SL	TITLE SLIDING SHELF ASSEMBLY, 19" EIA MOUNTING
QTY PER UNIT: 1	GREAT LAKES CASE & CABINET CO., INC. P.O. BOX 551 EDINBORO, PA 16412 PHONE (814) 734-7303 FAX (814) 734-3907 E-MAIL glcc@greatcabinets.com
MATERIAL TYPE: N/A	
MATERIAL GAUGE: #16 GA	
FINISH: N/A	
DATE: 10/28/02	DWG NO: 1000901
CHECKED: -	REV: 4
	SHEET 1 OF 1