

REVISION HISTORY			
REV	DESCRIPTION	DATE	APPROVED
0	ECO-01292	8/29/2003	WSS
1	ECO-01681	12/30/2005	WSS
2	ECO-02616	8/3/2009	FED

Bill of Material					FILE NAME	REV
ITEM	PART NUMBER	STOCK NU	QTY	DESCRIPTION		
1			1	SIDE PANEL, SOLID, LIFT OFF, FOR 60"H X 32"D ECONOMY ENHANCED	1001650.iam	2
2	10117-32728	H19-037	1	Austin 10117-32728 Black Lock, or PENN, KEY 1333	10117-32728.iam	-
3	2000614	H17-010	1	LOCK CAM, 14mm GRIP, L=35mm, ZN. PL. DIRAK or EQUIV.	2000614.ipt	-
4	A34062512		2	SOUTHCO SLIDE LATCH, FLUSH	A34062512.ipt	-

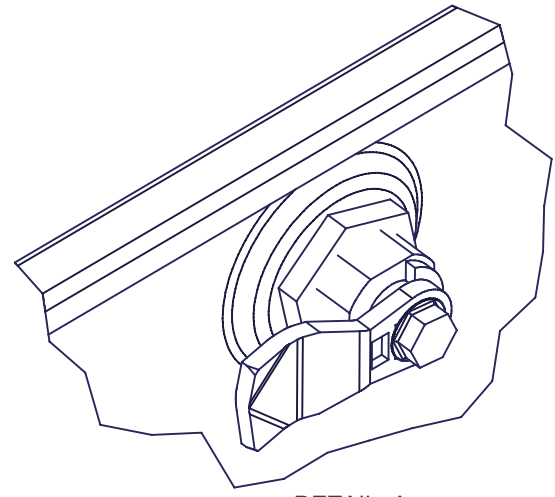

DETAIL A
ASSEMBLED VIEW OF LOCK AND CAM
CAM SHOWN IN UNLOCKED POSITION

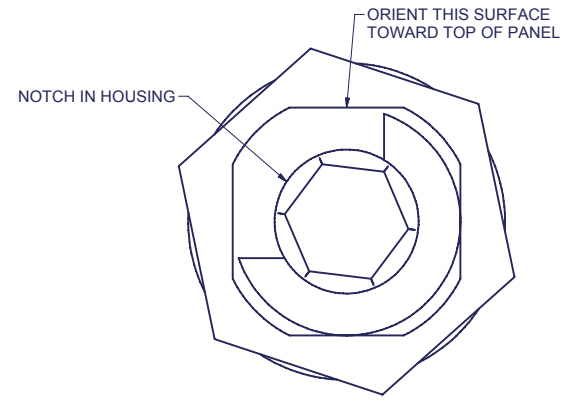

VIEW5
AS VIEWED FROM THE INSIDE

EXPLODED VIEW OF LOCK AND CAM
CAM SHOWN IN UNLOCKED POSITION

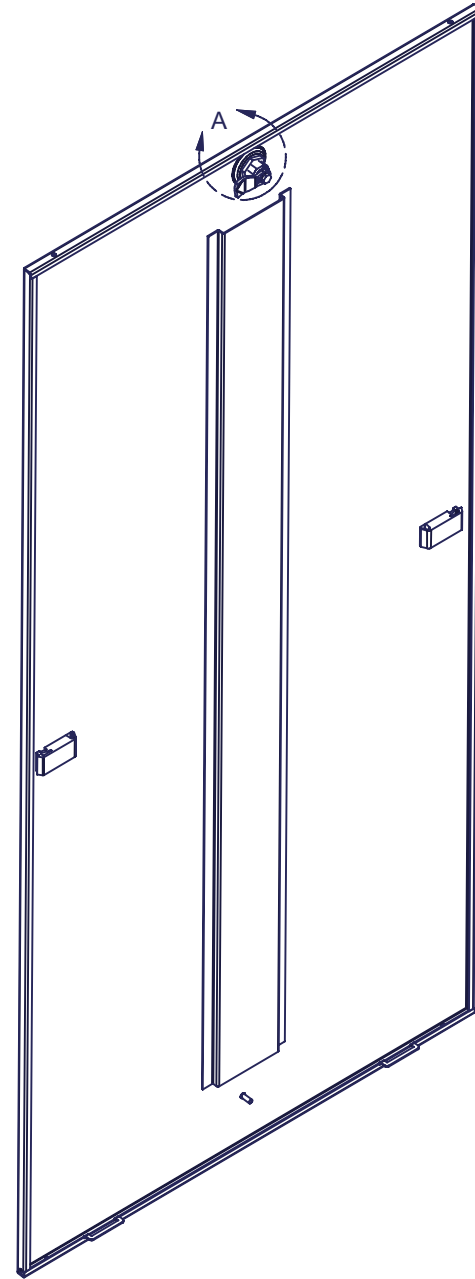
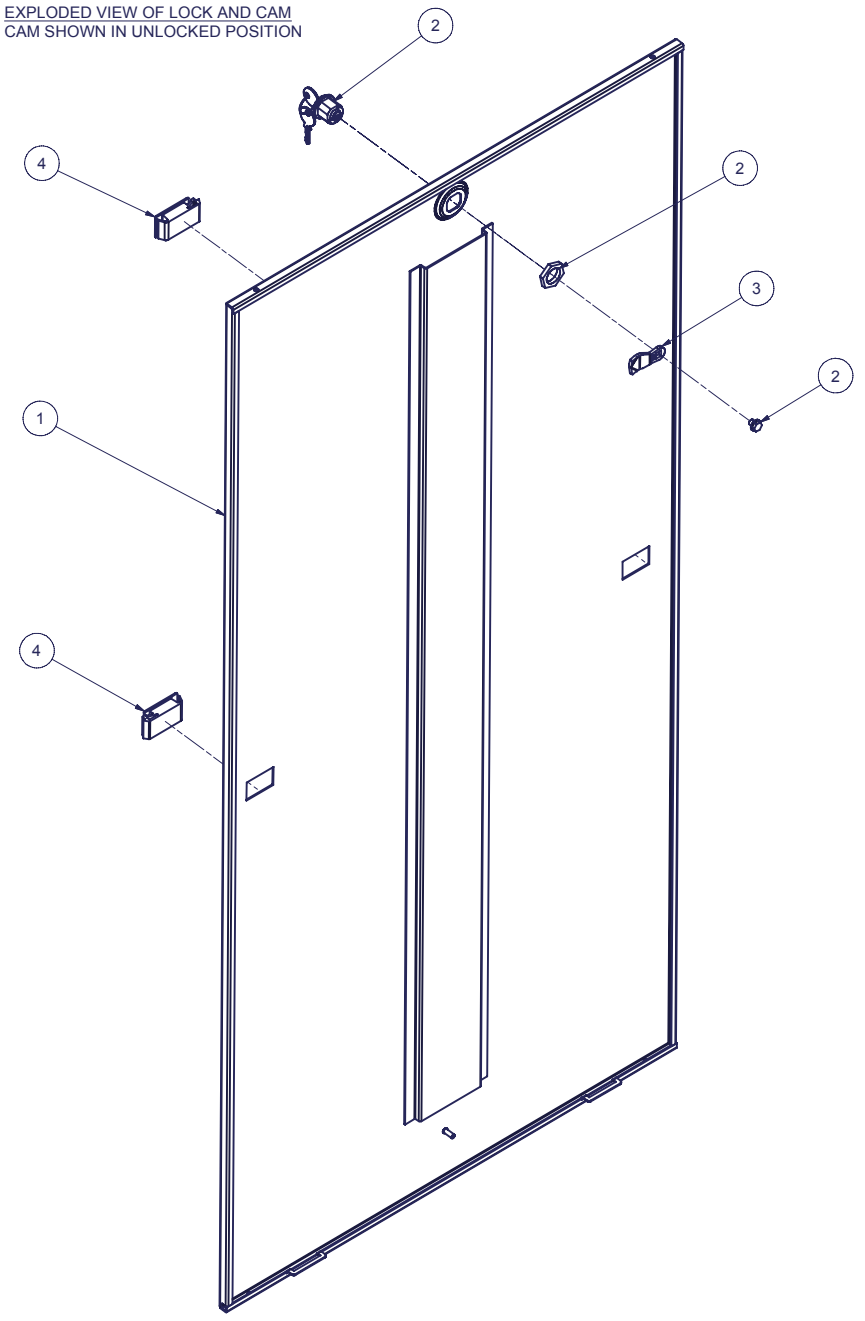

LOCK AND CAM ASSEMBLY:

1. DO NOT REMOVE KEY FROM LOCK CYLINDER WHEN CYLINDER IS NOT IN THE LOCK HOUSING, LOCK MECHANISM WILL BE DESTROYED.
2. POSITION LOCK HOUSING AS SHOWN IN VIEW 3 - NOTE ORIENTATION OF NOTCH ON ITS INSIDE SURFACE AND THE ORIENTATION OF THE KEY IN CYLINDER.
3. SECURE LOCK HOUSING WITH NUT.
4. POSITION CAM AS SHOWN AND SECURE WITH SCREW.
5. TURN KEY TO VERIFY SMOOTH OPERATION OF LOCK.

NOTE:

- 1) REFER TO PURCHASE ORDER - SPECIAL INSTRUCTIONS MAY APPLY.

INTERPRET DRAWING PER ASME Y14.5M-1994 DIMENSIONAL LIMITS APPLY AFTER APPLICATION OF FINISH DRAWING NOT TO SCALE TOLERANCE UNLESS OTHERWISE NOTED: ANGULAR +/- .1° .XXXX +/- .010 .XXX +/- .015 .XX +/- .030 .X FOR REF. ONLY	NOTICE: Use of this document is subject to a confidentiality and nondisclosure agreement with Great Lakes Case & Cabinet Co., Inc. (GLCC) and may not be reproduced, disclosed or utilized in whole or in part without prior written authorization from GLCC.	PART NUMBER: 6010321ELSX100	TITLE: SOLID SIDE PANEL ASSEMBLY FOR 60"H X 32"D ECONOMY ENHANCED ENCLOSURE
		QTY PER UNIT: 1	GREAT LAKES CASE & CABINET CO., INC. P.O. BOX 551 EDINBORO, PA 16412 PHONE (814) 734-7303 FAX (814) 734-3907 E-MAIL glcc@greatcabinets.com
		MATERIAL TYPE: N/A	
		MATERIAL GAUGE: N/A	
FINISH: N/A	DRAWN WSS	DATE 8/29/2003	DWG NO: 1001649
CHECKED & APP. C.A.	DATE 8/29/03	REV 2	SHEET: 1 OF 1



REVISION HISTORY			
REV	DESCRIPTION	DATE	APPROVED
0	ECO-01292	8/29/2003	WSS
1	ECO-01681	12/30/2005	WSS
2	ECO-02616	8/3/2009	FED

Bill of Material						
ITEM	PART NUMBER	STOCK NU	QTY	DESCRIPTION	FILE NAME	REV
1			1	SIDE PANEL, SOLID, LIFTOFF, FOR 60"H x 32"D E CABINET	I001650.ipt	1
2	101208260	H08-014	1	#10-32 x 1/2"L WELD STUD (NELSON)	101208260.ipt	-
3			1	STIFFENER FOR 60" SIDE PANELS - ECONOMY ENHANCED	I001675.ipt	1

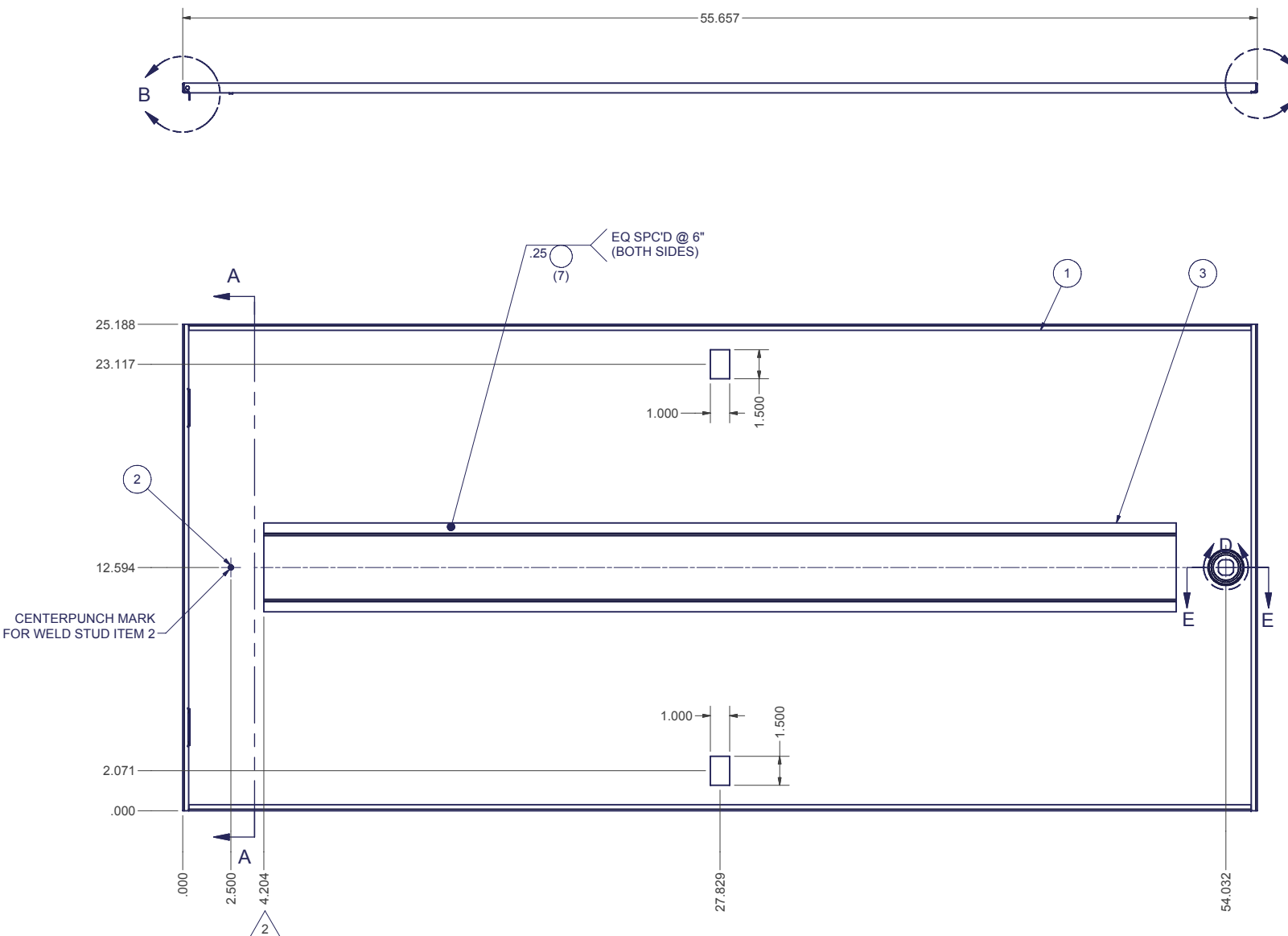
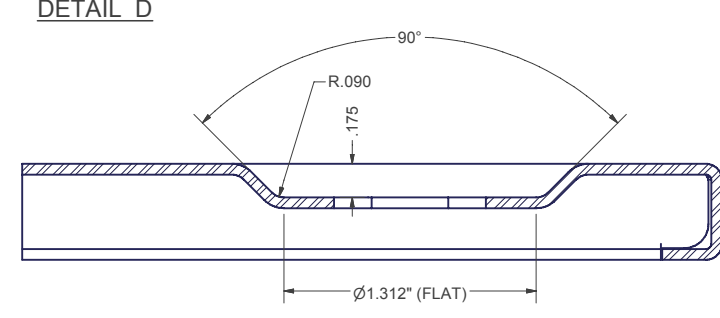
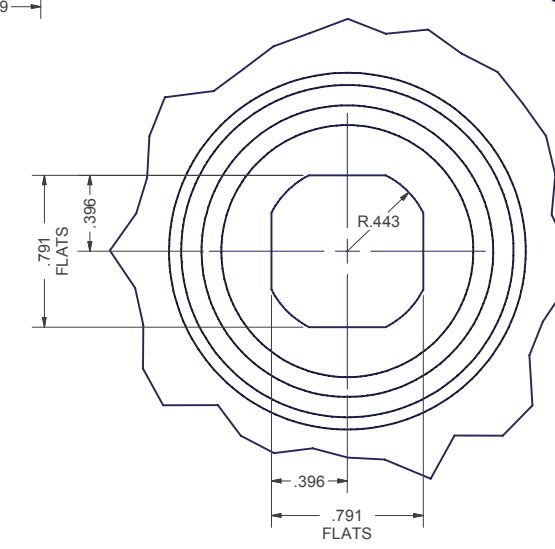
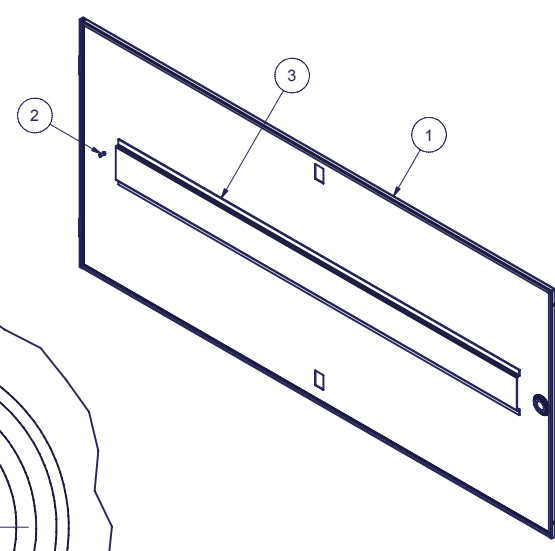
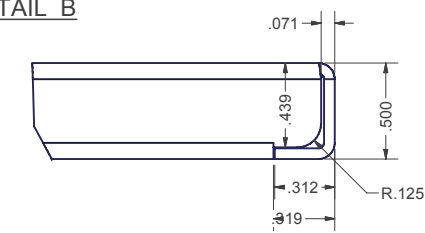
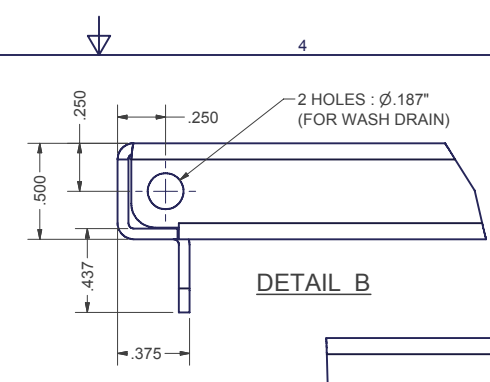
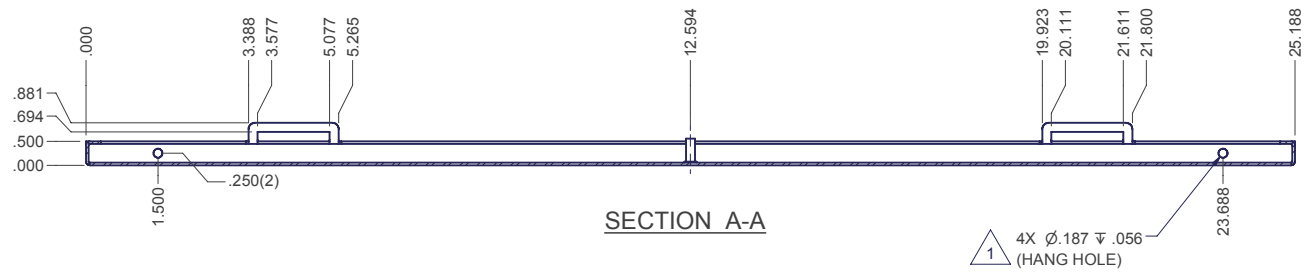

- SPECIAL NOTES:**
1. FINISH PER TD-09-103 (POWDER COAT), CLASS B, TEXTURE LEVEL 3, - ALL SURFACES UNLESS OTHERWISE NOTED.
 2. DIMENSIONS SHOWN ARE UNCOATED MEASUREMENTS : EITHER ADD OR SUBTRACT .005" PER SURFACE WHEN INSPECTING AFTER POWDER COAT.
 3. ALL BENDS 90° UNLESS OTHERWISE SPECIFIED.
 4. TYPICAL BEND RADIUS = 0.030" INSIDE.
 5. INSTALL ITEM 2 ON CENTER PUNCH MARK.
 6. MASK OFF ITEM 2, WELD STUD, QTY (1).

INTERPRET DRAWING PER ASME Y14.5M-1994 DIMENSIONAL LIMITS APPLY AFTER APPLICATION OF FINISH DRAWING NOT TO SCALE TOLERANCE UNLESS OTHERWISE NOTED: ANGULAR +/- .1" .XXXX +/- .010 .XXX +/- .015 .XX +/- .030 .X FOR REF. ONLY	NOTICE: Use of this document is subject to a confidentiality and nondisclosure agreement with Great Lakes Case & Cabinet Co., Inc. (GLCC) and may not be reproduced, disclosed or utilized in whole or in part without prior written authorization from GLCC.	PART NUMBER: QTY PER UNIT: 1 MATERIAL TYPE: C.R.S. MATERIAL GAUGE: #16 GA. FINISH: SEE NOTES	TITLE: SIDE PANEL, SOLID, LIFT OFF, FOR 60"H X 32"D ECONOMY ENHANCED GREAT LAKES CASE & CABINET CO., INC. P.O. BOX 551 EDINBORO, PA 16412 PHONE (814) 734-7303 FAX (814) 734-3907 E-MAIL glcc@greatcabinets.com
		DRAWN: WSS CHECKED & APP. C.A.	DATE: 8/29/2003 DATE: 8/28/03
		DWG NO: 1001650	REV: 2
		SHEET: 1 OF 1	

