

6 COMPLETE REDESIGN

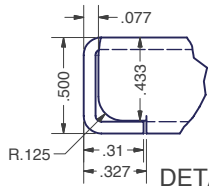

DETAIL A
TYP 4 CORNERS

Bill of Material					
ITEM	PART NUMBER	QTY	DESCRIPTION	FILE NAME	REVISION
1	-	1	29" WIDE ENHANCED SOLID TOP PANEL	I000174.ipt	6
2	BPF375	2	BUTTON PLUG, FLUSH TYPE - BLACK	BPF375.ipt	-
3	SCR1032X1BLK23	4	#10-32 x 1"L PAN HEAD PHIL TYPE 23, BLACK	SCR1032X1BLK23.ipt	-
4	17W04379B	4	BLACK NYLON WASHER (.196 DIA x .437 DIA)	17W04379B.ipt	-

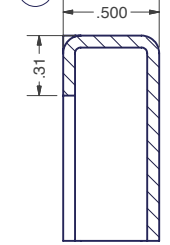
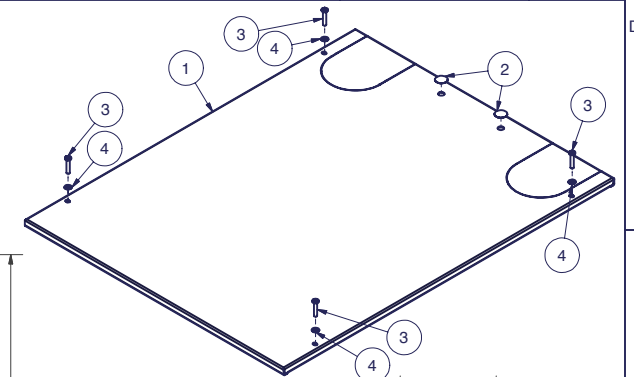
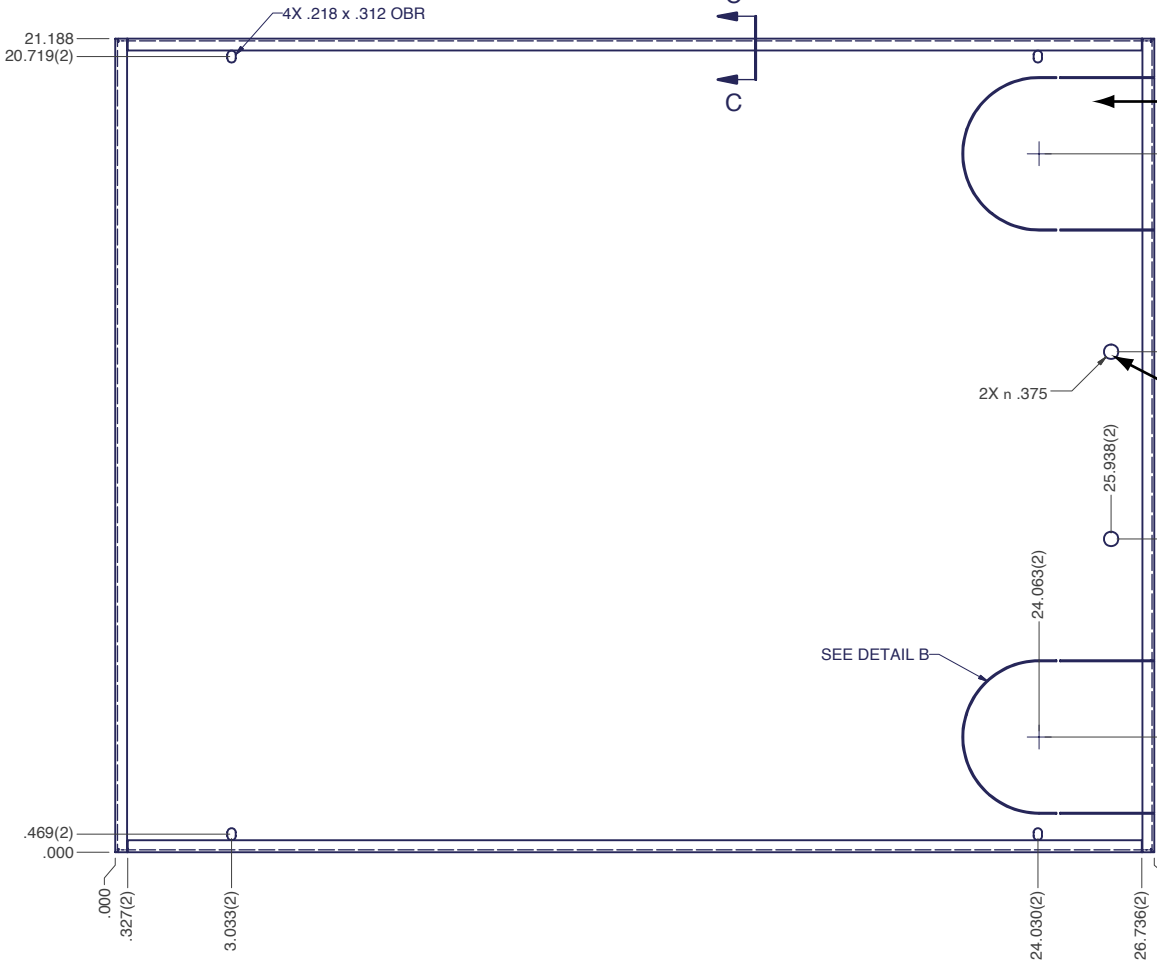
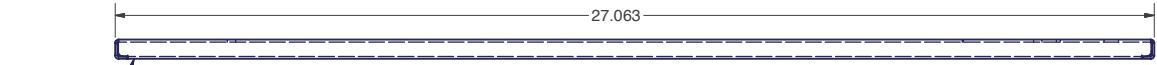

SECTION C-C
TYP 4 SIDES

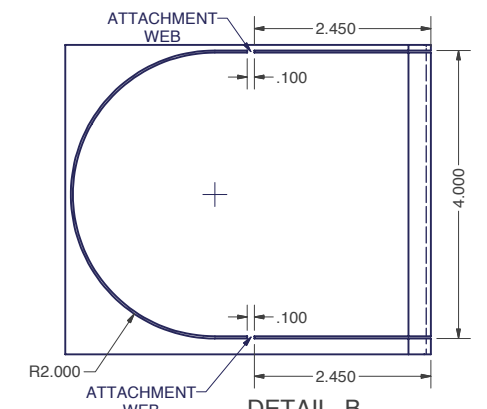

DETAIL B
TYP 2 PLACES

Note: Durable Powder Coat Finish

INTERPRET DRAWING PER ASME Y14.5M-1994
DIMENSIONAL LIMITS APPLY AFTER APPLICATION OF FINISH
DRAWING NOT TO SCALE
TOLERANCE UNLESS OTHERWISE NOTED:
ANGULAR +/- 1-
.XXXX +/- .010
.XXX +/- .015
.XX +/- .030
.X FOR REF. ONLY

NOTICE:

Use of this document is subject to a confidentiality and nondisclosure agreement with Great Lakes Case & Cabinet Co., Inc. (GLCC) and may not be reproduced, disclosed or utilized in whole or in part without prior written authorization from GLCC.

PART NUMBER:
TPE29S
QTY PER UNIT: 1
MATERIAL TYPE: CRS
MATERIAL GAUGE: 16 GA
FINISH: SEE NOTES
DRAWN: CA
DATE: 2/26/2003
CHECKED & APP. DATE: 2-28-03

TITLE
29" WIDE ENHANCED SOLID TOP PANEL
GREAT LAKES CASE & CABINET CO., INC.
P.O. BOX 551 EDINBORO, PA 16412
PHONE (814) 734-7303 FAX (814) 734-3907
E-MAIL glcc@greatcabinets.com



UNLESS OTHERWISE SPECIFIED ALL DIMENSIONS ARE IN INCHES

DWG NO: I000174
REV: 6
SHEET: 1 OF 1