

REVISION HISTORY			
REV	DESCRIPTION	DATE	APPROVED
0	ECO-06561	5/12/15	TAD

Bill of Material						
ITEM	PART NUMBER	STOCK NUMBER	QTY	DESCRIPTION	FILE NAME	REV
1	I024375		1	RIGHT- HAND FIBER BOX CHASSIS - WELDMENT	I024375.iam	0
2	I024379		1	FIBER BOX COVER DETAIL	I024379.ipt	0
3		H01-073	4	SCREW, 10-32x1/4 PH PAN TYPE 23 BLACK ZINC RoHS	H01-073.ipt	-

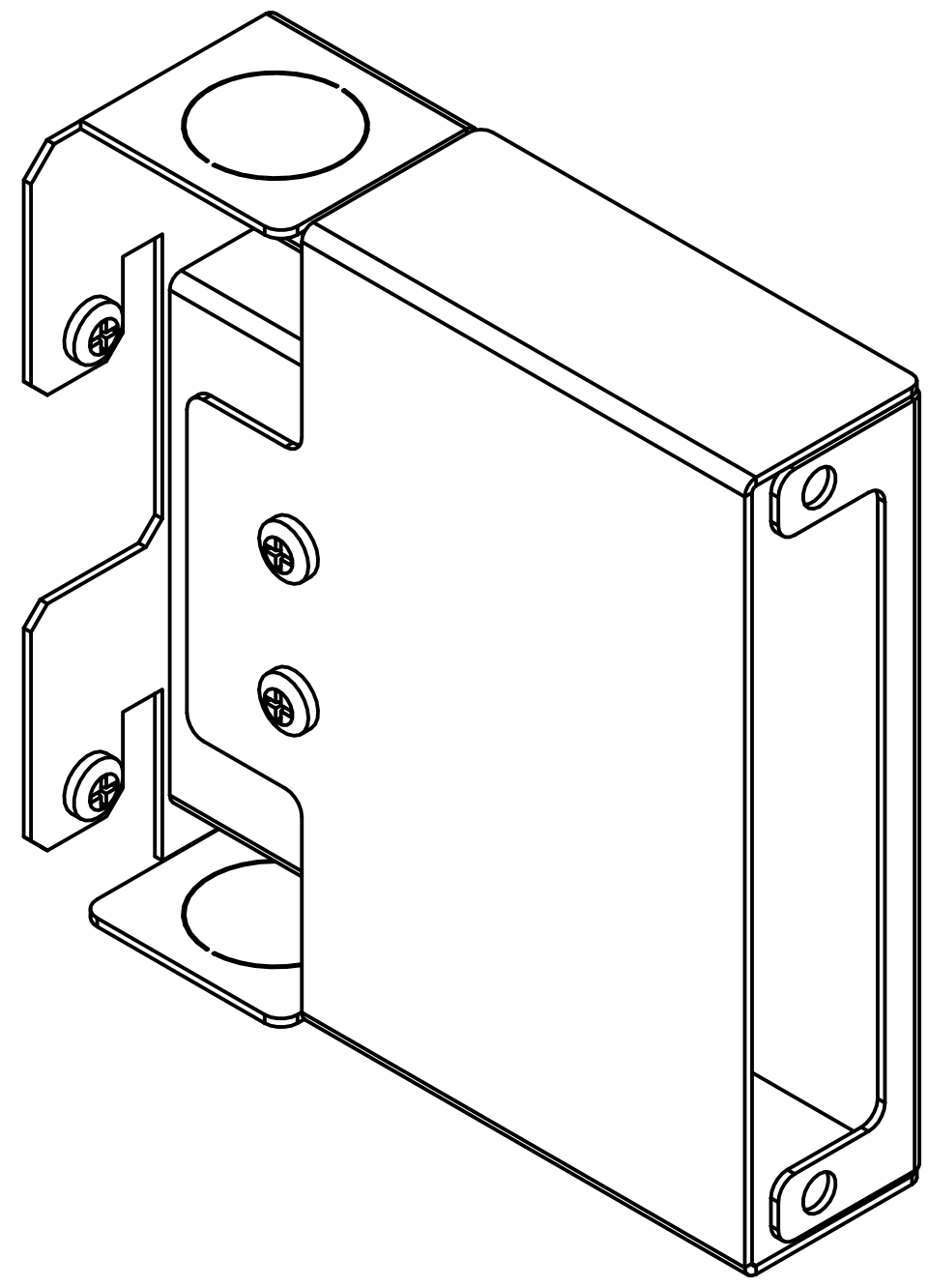

ASSEMBLED VIEW

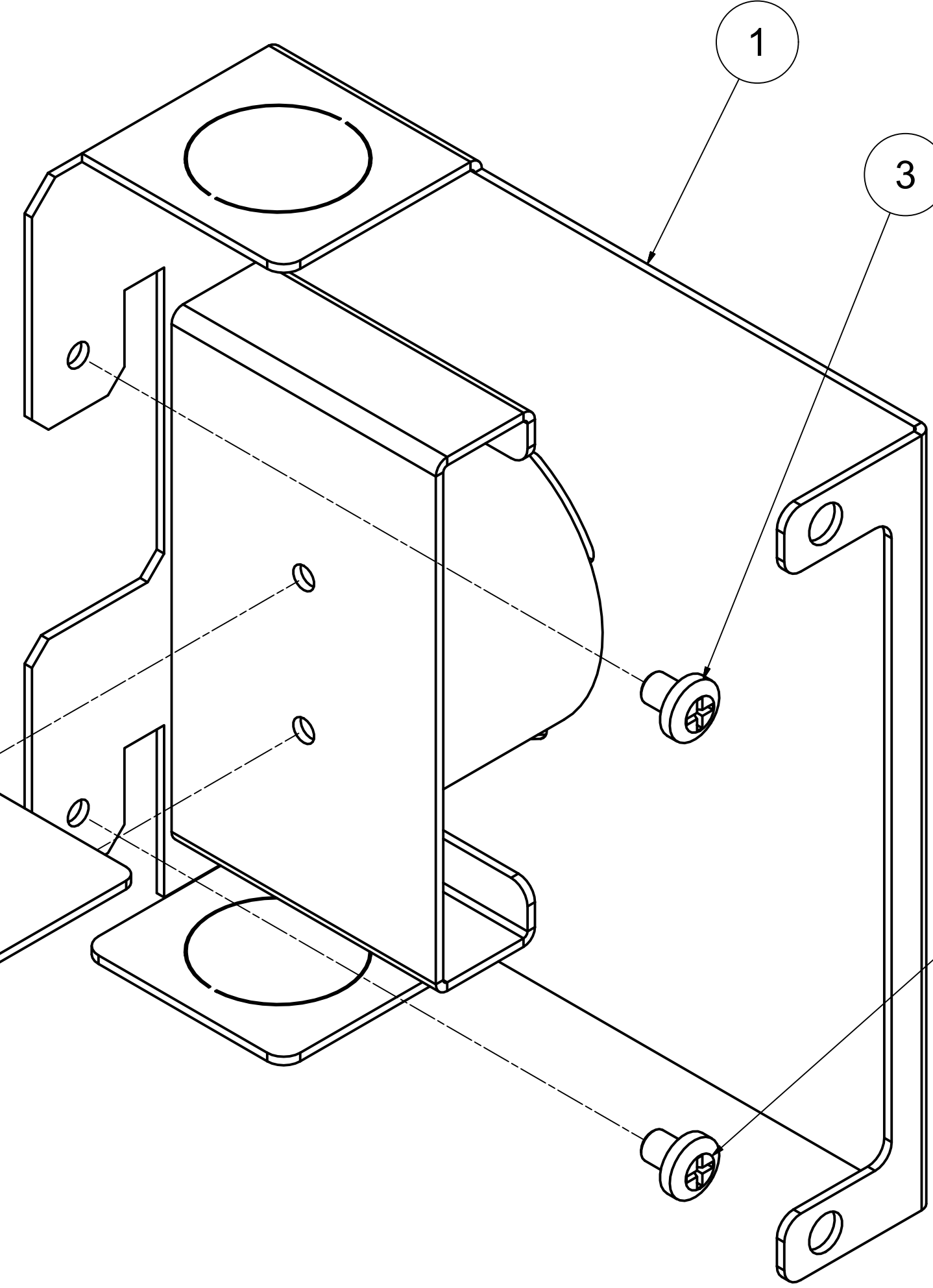

EXPLODED VIEW

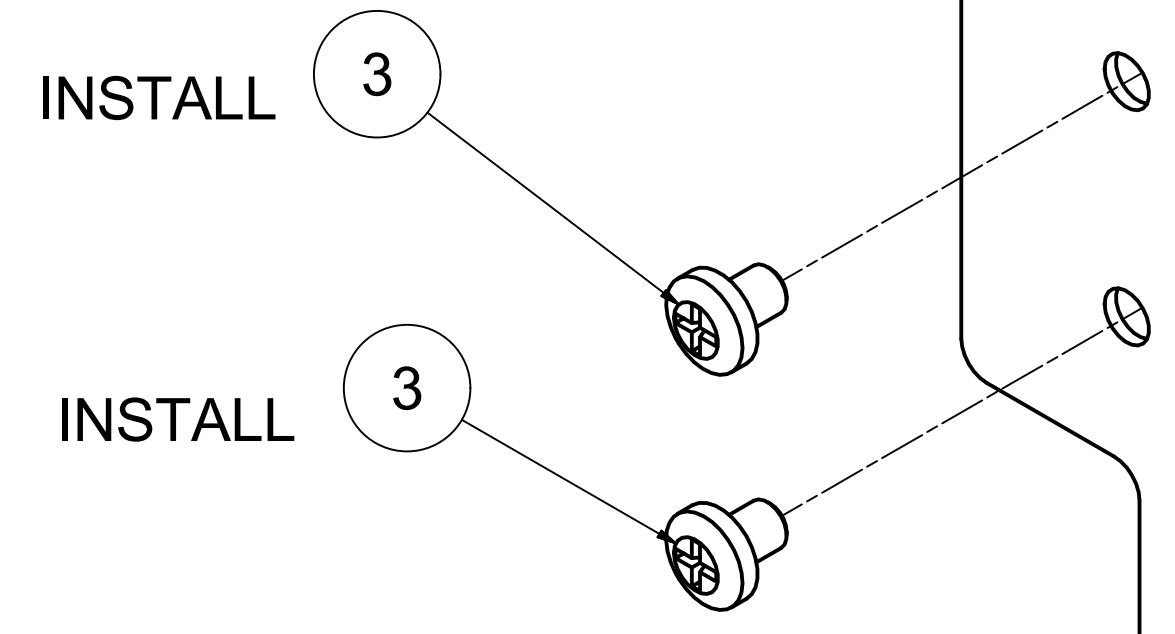

1

3 DO NOT INSTALL

3 DO NOT INSTALL

SPECIAL NOTE:

- 1) PLEASE REFERENCE PURCHASE ORDER - SPECIAL REQUIREMENTS MAY APPLY!
- 2) PLACE EXTRA SCREWS IN SMALL PLASTIC BAG TAPED TO ASSEMBLY.

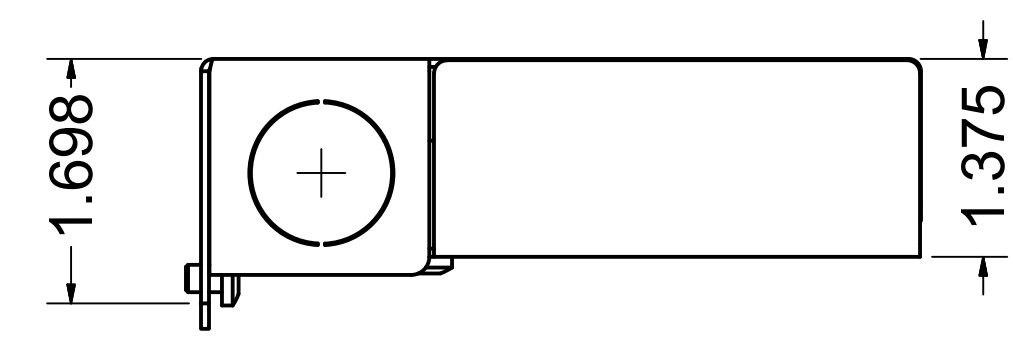

TOP VIEW

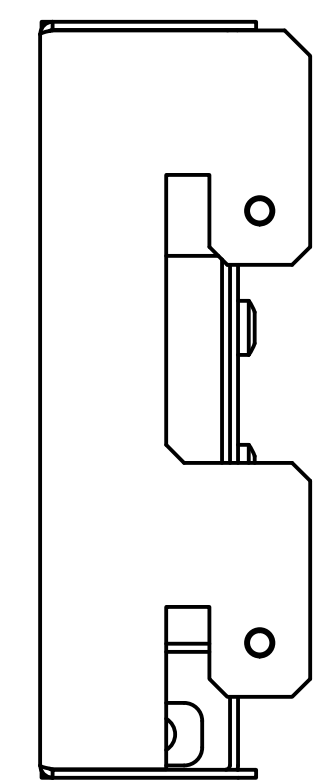

BACK VIEW

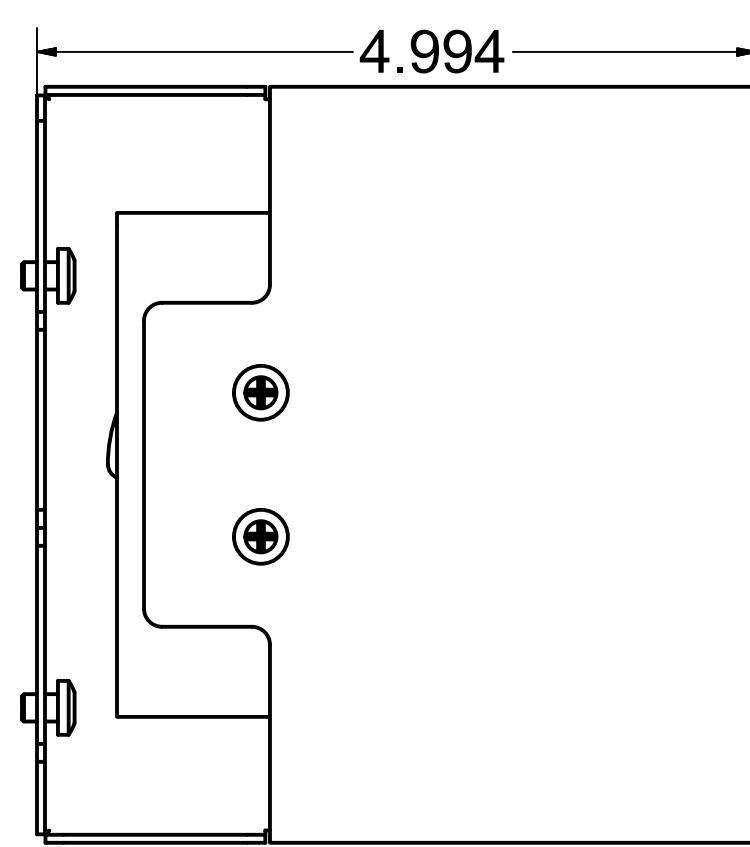

LEFTSIDE VIEW

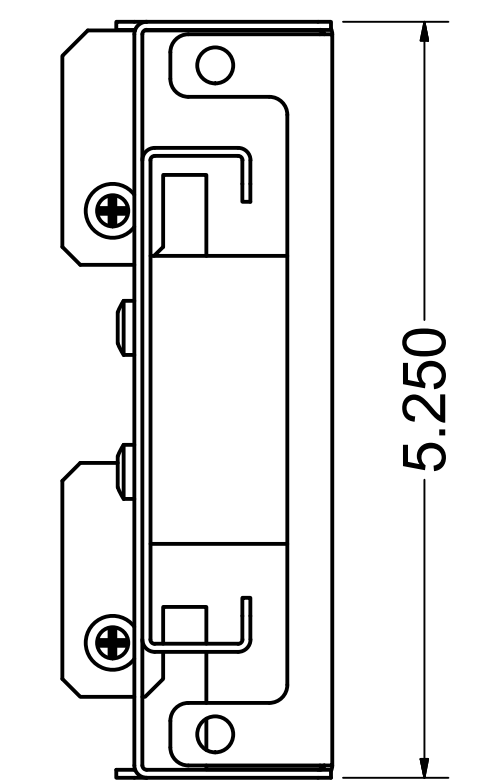

FRONT VIEW

EST. WEIGHT :
N/A

THIRD ANGLE PROJECTION

INTERPRET DRAWING PER ASME Y14.5M-1994
DIMENSIONAL LIMITS APPLY
AFTER APPLICATION OF FINISH
DRAWING NOT TO SCALE
TOLERANCE UNLESS OTHERWISE NOTED:
ANGULAR +/- .1'
.XXXX +/- .010
.XXX +/- .015
.XX +/- .030
.X FOR REF. ONLY
UNLESS OTHERWISE SPECIFIED
ALL DIMENSIONS ARE IN INCHES

NOTICE:
Use of this document is subject to a confidentiality and nondisclosure agreement with Great Lakes Case & Cabinet Co., Inc. (GLCC) and may not be reproduced, disclosed or utilized in whole or in part without prior written authorization from GLCC.

PART NUMBER: WLPRHFBX100
QTY PER UNIT: 1
MATERIAL TYPE: CRS
MATERIAL GAUGE: SEE DETAILS
FINISH: POWDERCOATED
DRAWN DATE: 5/12/2015
TAD DATE: 5/12/2015
CHECKED & APP. DATE:

TITLE: RIGHT-HAND HOOK-MOUNTED FIBER BOX - ASSEMBLY
GREAT LAKES CASE & CABINET CO., INC.
P.O. BOX 551 EDINBORO, PA 16412
PHONE (814) 734-7303 FAX (814) 734-3907
E-MAIL glcc@greatcabinets.com
DWG NO: I024374
REV: 0
SHEET: 1 OF 1